

# STATE OF VERMONT AGENCY OF TRANSPORTATION

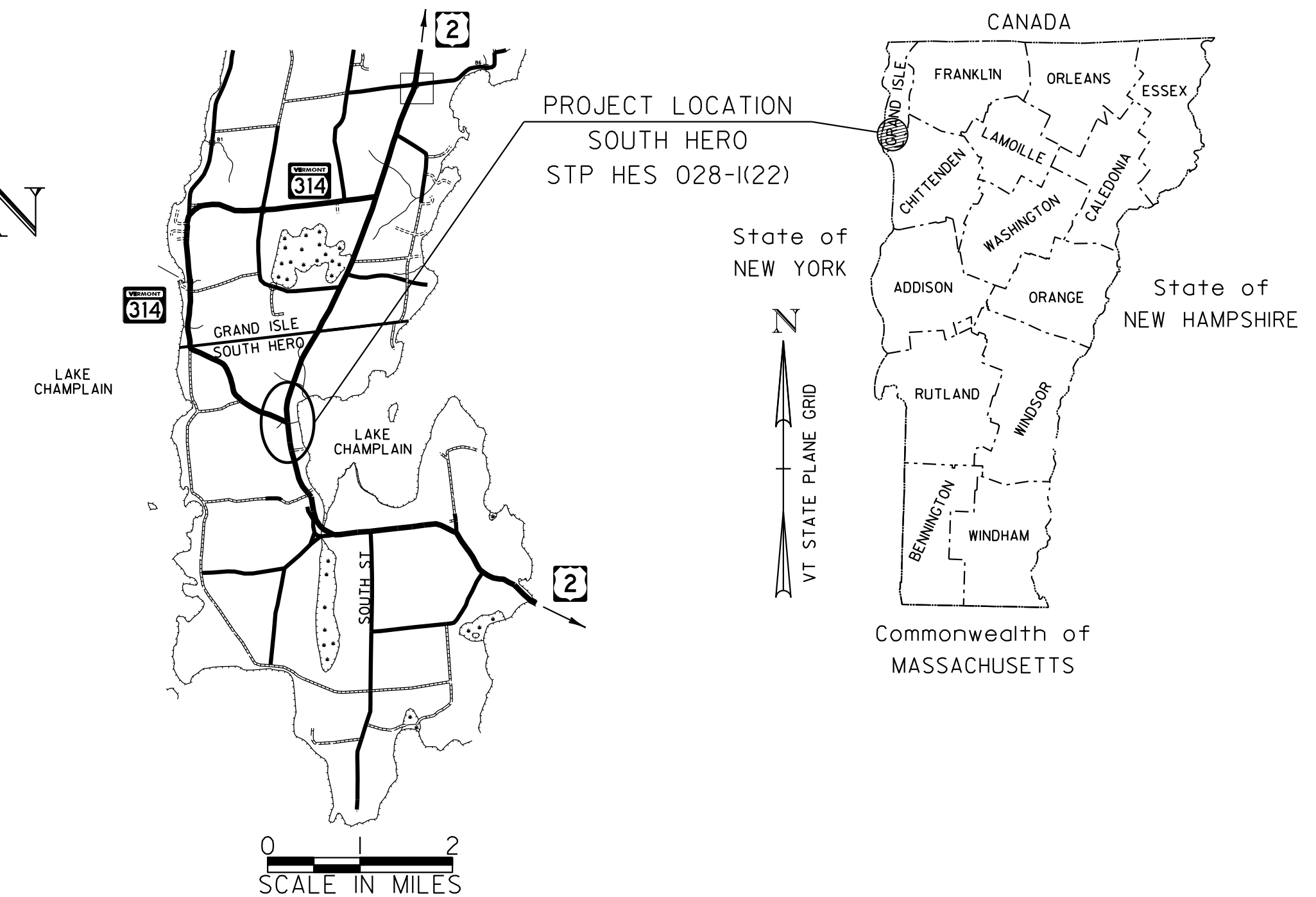

## PROPOSED IMPROVEMENT TOWN OF SOUTH HERO COUNTY OF GRAND ISLE US ROUTE 2 (MINOR ARTERIAL) VT ROUTE 314 (MAJOR COLLECTOR)



PROJECT LOCATION: BEGINNING IN THE TOWN OF SOUTH HERO ON US ROUTE 2 AT STATION 56+00.00 (MM 1.061) EXTENDING EASTERLY APPROXIMATELY 1200.00 FEET (0.227 MILES) TO STATION 68+00.00 (MM 1.288).

PROJECT DESCRIPTION: WORK TO BE PERFORMED UNDER THE PROJECT INCLUDES WIDENING US ROUTE 2 TO ACCOMMODATE A LEFT TURN LANE, REPLACEMENT OF A BOX CULVERT, APPROACH WORK ON VT ROUTE 314, AND OTHER HIGHWAY RELATED ITEMS.

LENGTH OF ROADWAY= 1189.94 FEET (0.225 MILES)  
LENGTH OF BRIDGE = 10.06 FEET (0.002 MILES)  
LENGTH OF PROJECT= 1200.00 FEET (0.227 MILES)

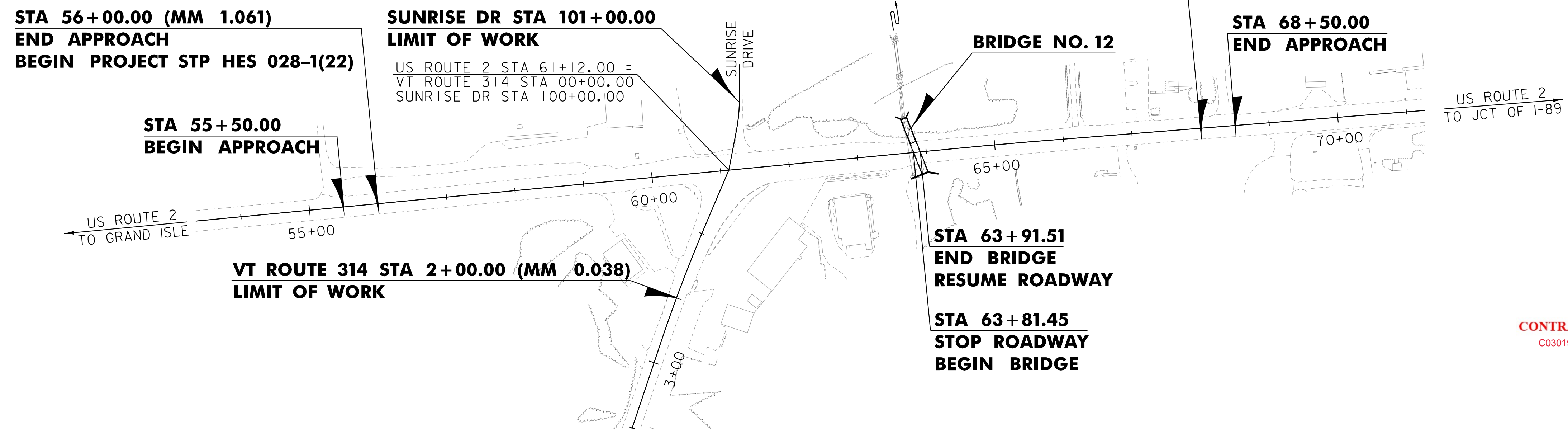

CONSTRUCTION IS TO BE CARRIED ON IN ACCORDANCE WITH THESE PLANS AND THE STANDARD SPECIFICATIONS FOR CONSTRUCTION DATED 2018, AS APPROVED BY THE FEDERAL HIGHWAY ADMINISTRATION ON APRIL 13, 2018 FOR USE ON THIS PROJECT, INCLUDING ALL SUBSEQUENT REVISIONS AND SUCH REVISED SPECIFICATIONS AND SPECIAL PROVISIONS AS ARE INCORPORATED IN THESE PLANS.

QUALITY ASSURANCE PROGRAM : LEVEL 2
SURVEYED BY : VSE
SURVEYED DATE : 6/2012
DATUM
VERTICAL NAVD 88 (GE10D09) FT
HORIZONTAL NAD 83 (CORS96) SFT

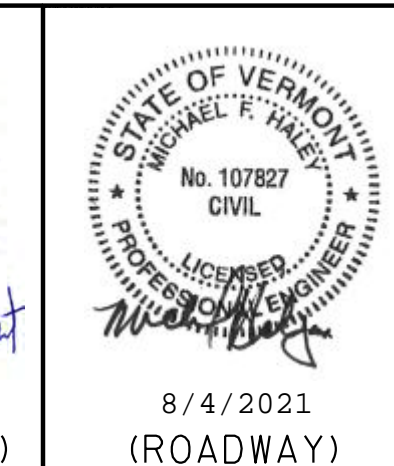
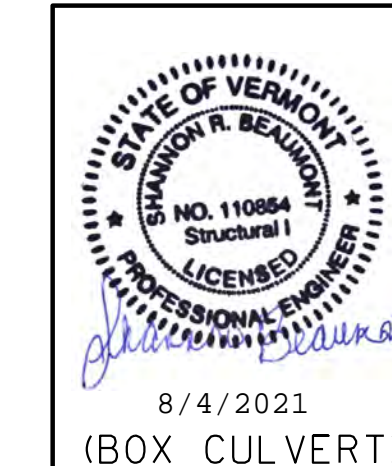
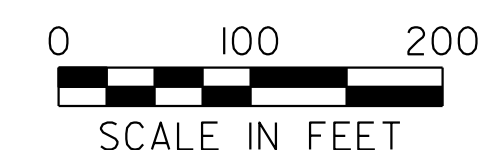

DIRECTOR OF PROJECT DELIVERY
APPROVED <i>Elin B. Parizo, P.E.</i> DATE Aug 9, 2021
PROJECT MANAGER : MICHAEL LaCROIX
PROJECT NAME : SOUTH HERO
PROJECT NUMBER : STP HES 028-1(22)
SHEET 1 OF 87 SHEETS

CONTRACT  
C03019

CONSTRUCT DRIVE  
 55+55 TO 58+75 LT - 13' WIDE, GRASS (SEE DETAIL ON TYPICAL SECTIONS SHEET 2)

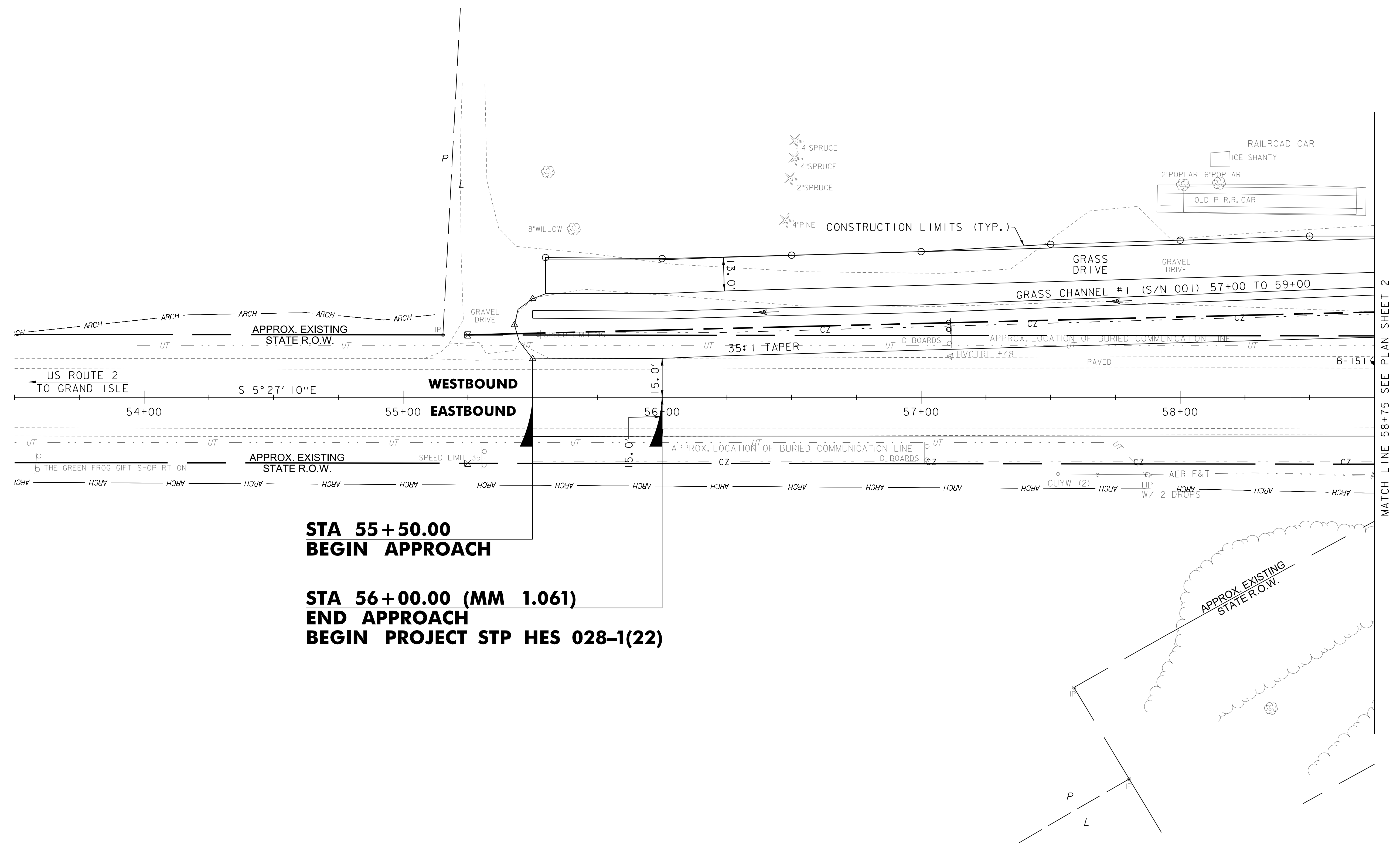
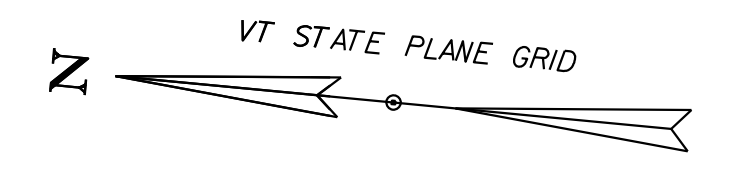

**STA 55+50.00  
 BEGIN APPROACH**

**STA 56+00.00 (MM 1.061)  
 END APPROACH  
 BEGIN PROJECT STP HES 028-1(22)**



SUBJECT TO VT OPERATIONAL  
 STORMWATER DISCHARGE  
 PERMIT #7809-INDS

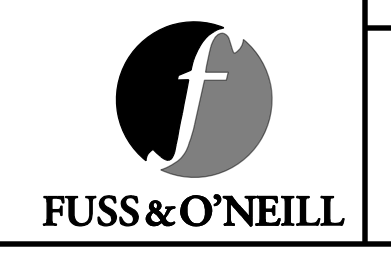

PROJECT NAME: SOUTH HERO	
PROJECT NUMBER: STP HES 028-1(22)	
FILE NAME: z12B016bdr.dgn	PLOT DATE: 8/5/2021
PROJECT LEADER: P. SHEDD	DRAWN BY: M. HALEY
DESIGNED BY: M. HALEY	CHECKED BY: P. SHEDD
PLAN SHEET 1	SHEET 27 OF 87

MATCH LINE 58+75 SEE PLAN SHEET 2

CURVE 1 (SUNRISE DRIVE)  
 DELTA = 10°47'08" LT  
 PI STA 100+82.66 BK=  
 STA 100+82.53 AH  
 D = 22°55'06"  
 R = 250.00'  
 T = 23.60'  
 L = 47.06'  
 E = 1.11'  
 PC = STA 100+59.06  
 PT = STA 101+06.13  
 BANK = NC

**SUNRISE DR STA 101+00.00  
 LIMIT OF WORK**

**VT ROUTE 314 STA 2+00.00 (MM 0.038)  
 LIMIT OF WORK**

CURVE 1 (VT 314)  
 DELTA = 4°28'08" LT  
 D = 2°32'47" GAS STATION  
 R = 2250.00'  
 T = 87.79'  
 L = 175.50'  
 E = 1.71'  
 BRC = AH N71°25'05"W  
 PT = STA 2+55.65  
 BANK = NC

**CONSTRUCT DRIVE**  
 58+75.0 TO 59+00.0 LT - 13' WIDE, GRASS  
 (SEE DETAIL ON TYPICAL SECTIONS SHEET 2)  
 59+50.0 RT - 40' WIDE, 4' APRON ONLY  
 59+81.0 LT - 40' WIDE, GRAVEL-COMM. (4' APRON)  
 62+20.0 RT - 53' WIDE, PAVED-COMM.  
 1+46.0 LT - 36' WIDE, PAVED-COMM.  
 1+56.0 RT - 20' WIDE, GRAVEL-COMM. (4' APRON)

**VERTICAL GRANITE CURB**  
 1+29.0 LT TO 61+85.0 RT (ISLAND)  
 1+65.5 TO 1+90.0 LT (ISLAND)

**VERTICAL GRANITE CURB, MOUNTABLE**  
 0+53.2 LT TO 61+63.5 RT

**REMOVAL OF EXISTING CURB**  
 1+25.5 LT TO 61+66.7 RT  
 1+65.5 LT TO 1+90.0 LT

**BITUMINOUS CONCRETE GUTTERS AND TRAFFIC ISLANDS**  
 62+50 TO 63+25 RT

**REMOVE AND RESET MAILBOX, SINGLE SUPPORT**  
 60+86 LT 60+92 LT  
 60+88 LT 60+94 LT  
 60+90 LT 60+96 LT

**SPECIAL PROVISION (HORIZONTAL DIRECTIONAL DRILLING) (12" CASING PIPE) (HDPE)**  
 61+00 TO 61+55 LT (1)  
 61+28 RT TO 61+55 LT (1)

**SPECIAL PROVISION (ADJUST ELEVATION OF MONITORING WELLS)**  
 61+69.9, 26.4' RT  
 61+92.7, 29.6' LT

**SPECIAL PROVISION (STAMPED CONCRETE ISLAND, 8 INCH)**  
 0+53.2 LT TO 61+63.5 RT

**SPECIAL PROVISION (JUNCTION BOX, HEAVY DUTY)**  
 61+00, 35.0' LT  
 61+28, 39.0' RT  
 61+55, 35.0' LT

**EXISTING DRAINAGE**

- 1 1+41.2 TO 1+71.5 RT  
 REMOVE EXISTING 18" CGMP PIPE
- 2 60+56.9 RT TO 61+61.3 LT  
 EXISTING 18" CGMP WITH HEADWALL AT INLET  
 REMOVE HEADWALL AND FILL AND ABANDON PIPE

**NEW DRAINAGE**

- 1 1+25.4, 32.5' RT TO 1+71.6, 21.7' RT  
 NEW 18" X 48.0' CPEP (SL)  
 INV IN = 125.88, INV OUT = 124.20
- 2 60+33.4, 45.0' RT TO 61+63.5, 14.0' RT  
 NEW 18" X 130.2' CPEP (SL)  
 NEW 4' DIA. PRCCB W/CI GRATE TYPE A AT  
 60+33.4, 45.0' RT
- 3 61+63.5, 14.0' RT TO 61+63.5, 26.2' LT  
 NEW 18" X 36.6' CPEP (SL)  
 NEW 4' DIA. PRCCB W/CI GRATE TYPE D AT  
 61+63.5, 14.0' RT
- 4 61+63.5, 26.2' LT TO 62+63.0, 48.7' LT  
 NEW 18" X 100.2' CPEP (SL) W/ END SECTION AT  
 OUTLET  
 NEW 4' DIA. PRCMH W/CI COVER AT 61+63.5,  
 26.2' LT  
 CONSTRUCT STONE FILL, TYPE II AT OUTLET  
 SEE STONE FILL APRON DETAIL ON DETAIL SHEET 1

PROJECT NAME: SOUTH HERO  
 PROJECT NUMBER: STP HES 028-1(22)

FILE NAME: z12B016bdr.dgn  
 PROJECT LEADER: P. SHEDD  
 DESIGNED BY: M. HALEY  
 PLAN SHEET 2

PLOT DATE: 8/5/2021  
 DRAWN BY: M. HALEY  
 CHECKED BY: P. SHEDD  
 SHEET 28 OF 87

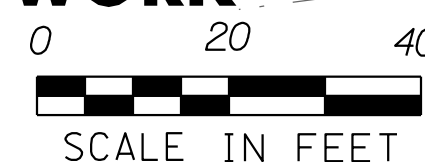
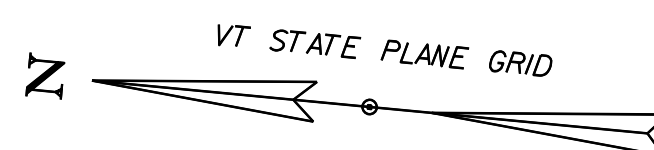

SUBJECT TO VT OPERATIONAL  
 STORMWATER DISCHARGE  
 PERMIT #7809-INDS

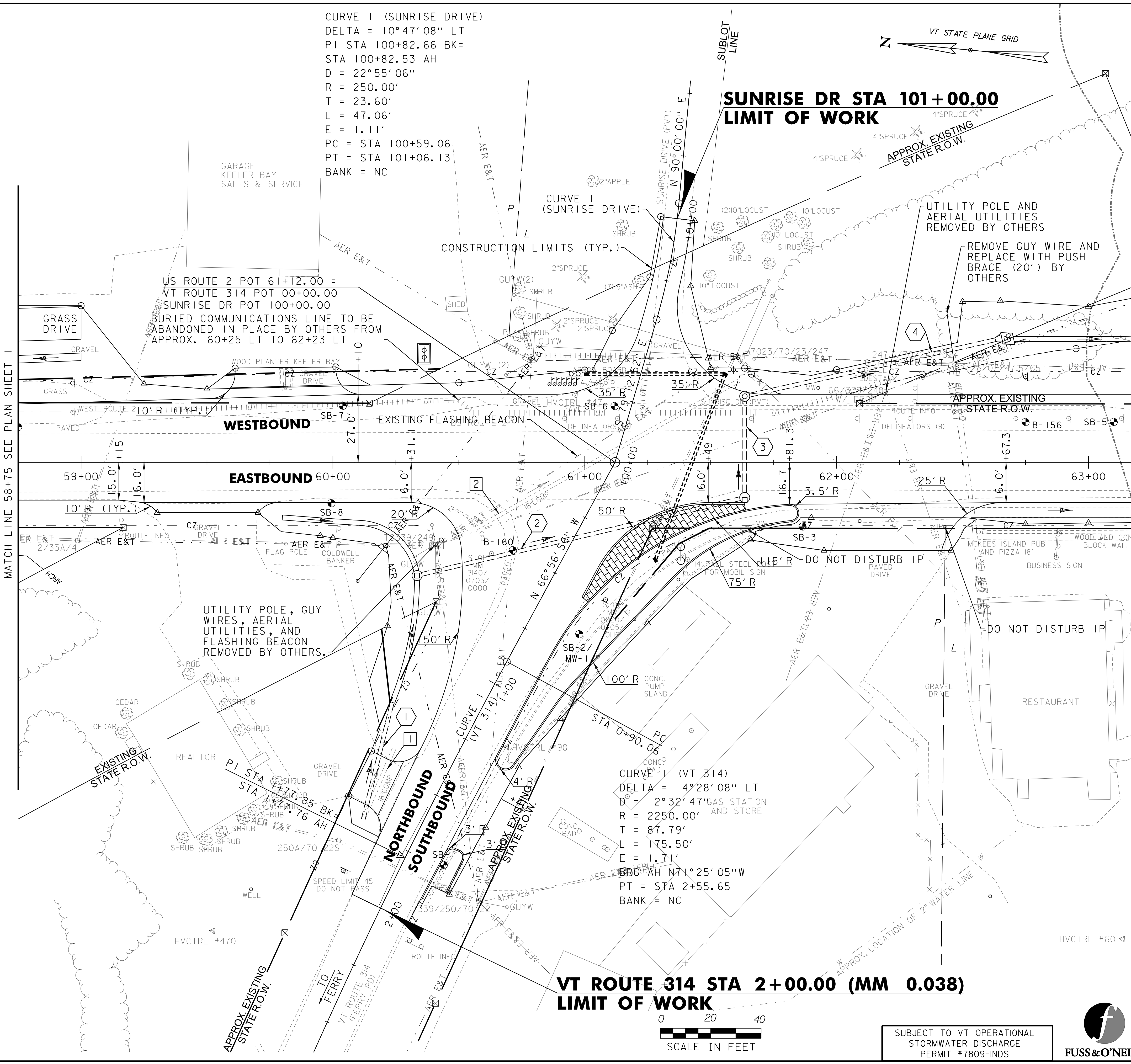

MATCH LINE 58+75 SEE PLAN SHEET 1

MATCH LINE 63+25 SEE PLAN SHEET 3



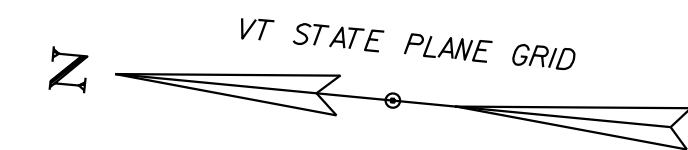

CONSTRUCT DRIVE  
 66+84.6 RT - 14' WIDE, 4' APRON ONLY  
 67+16.8 LT - 18' WIDE, GRAVEL-RES. (4' APRON)  
 68+37.3 LT - 29' WIDE, 4' APRON ONLY

REMOVE AND RESET MAILBOX, MULTIPLE SUPPORT  
 66+89 LT

EXISTING DRAINAGE  
 5 67+01.4 TO 67+31.5 LT  
 REMOVE EXISTING 15" CGMP PIPE

NEW DRAINAGE  
 7 66+97.6, 31.5' LT TO 67+28.0, 28.7' LT  
 NEW 15" X 30.5' RCP CLASS III  
 W/ END SECTIONS AT INLET AND OUTLET  
 INV IN=130.60, INV OUT=129.87

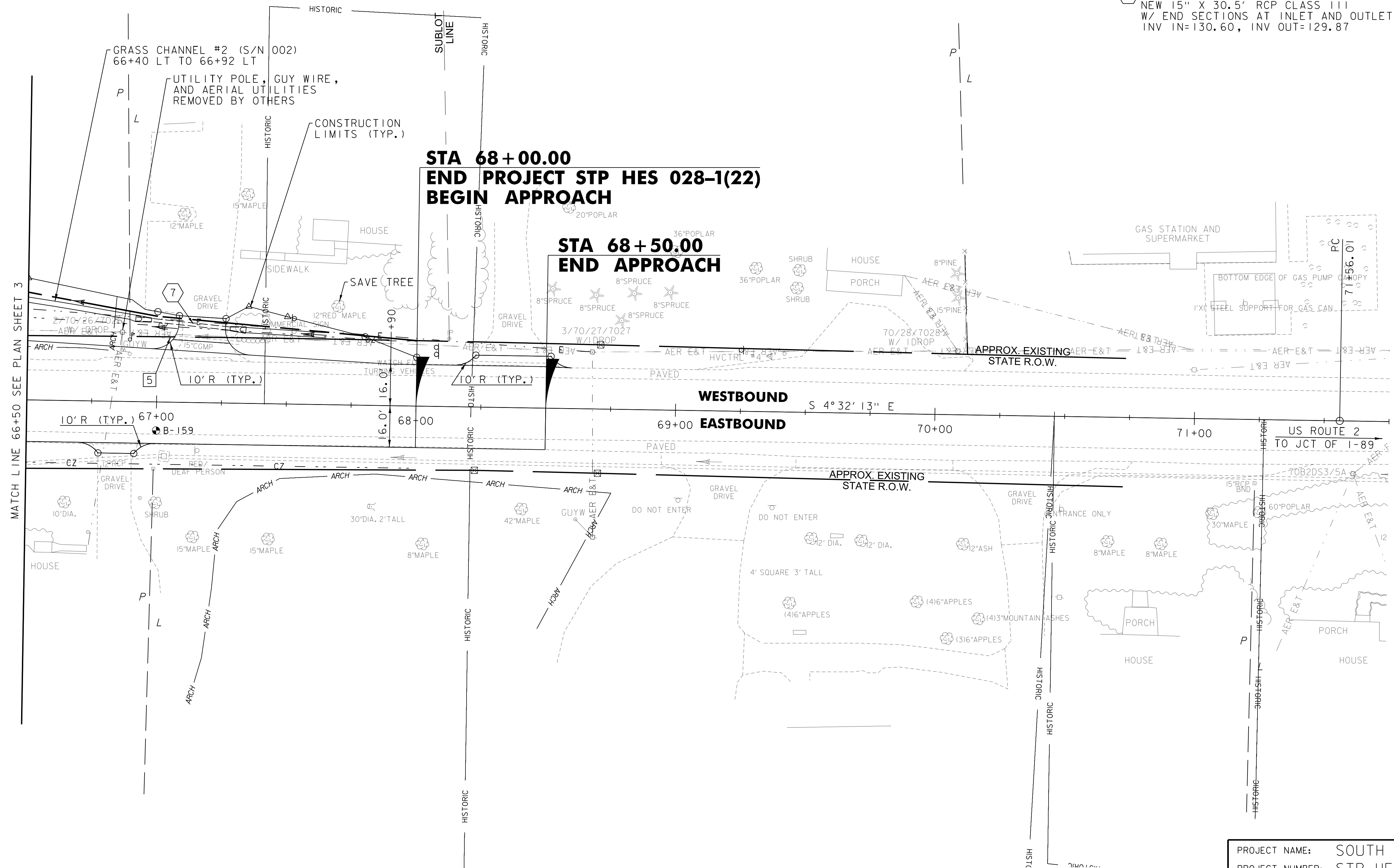

MATCH LINE 66+50 SEE PLAN SHEET 3



SUBJECT TO VT OPERATIONAL  
 STORMWATER DISCHARGE  
 PERMIT #7809-INDS



PROJECT NAME:	SOUTH HERO
PROJECT NUMBER:	STP HES 028-1(22)
FILE NAME:	z12B016bdr.dgn
PROJECT LEADER:	P. SHEDD
DESIGNED BY:	M. HALEY
PLAN SHEET 4	
PLOT DATE:	8/5/2021
DRAWN BY:	M. HALEY
CHECKED BY:	P. SHEDD
SHEET	30 OF 87

TEMPORARY 4 INCH WHITE LINE, PAINT  
 DURABLE 4 INCH WHITE LINE, RECESSED POLYUREA  
 55+50 TO 58+75 LT (SOLID)  
 55+50 TO 58+75 RT (SOLID)

DURABLE 8 INCH YELLOW LINE, RECESSED POLYUREA  
 57+51 TO 58+75 LT (SOLID) (DIAGONALS)

REMOVING SIGNS  
 AS SHOWN - 4

TEMPORARY 4 INCH YELLOW LINE, PAINT  
 DURABLE 4 INCH YELLOW LINE, RECESSED POLYUREA  
 55+50 TO 56+50 LT & RT (SOLID)  
 56+50 TO 58+75 LT & RT (DOUBLE SOLID)

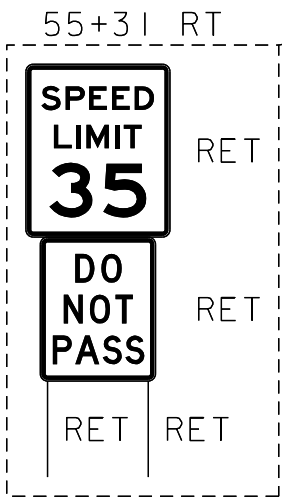
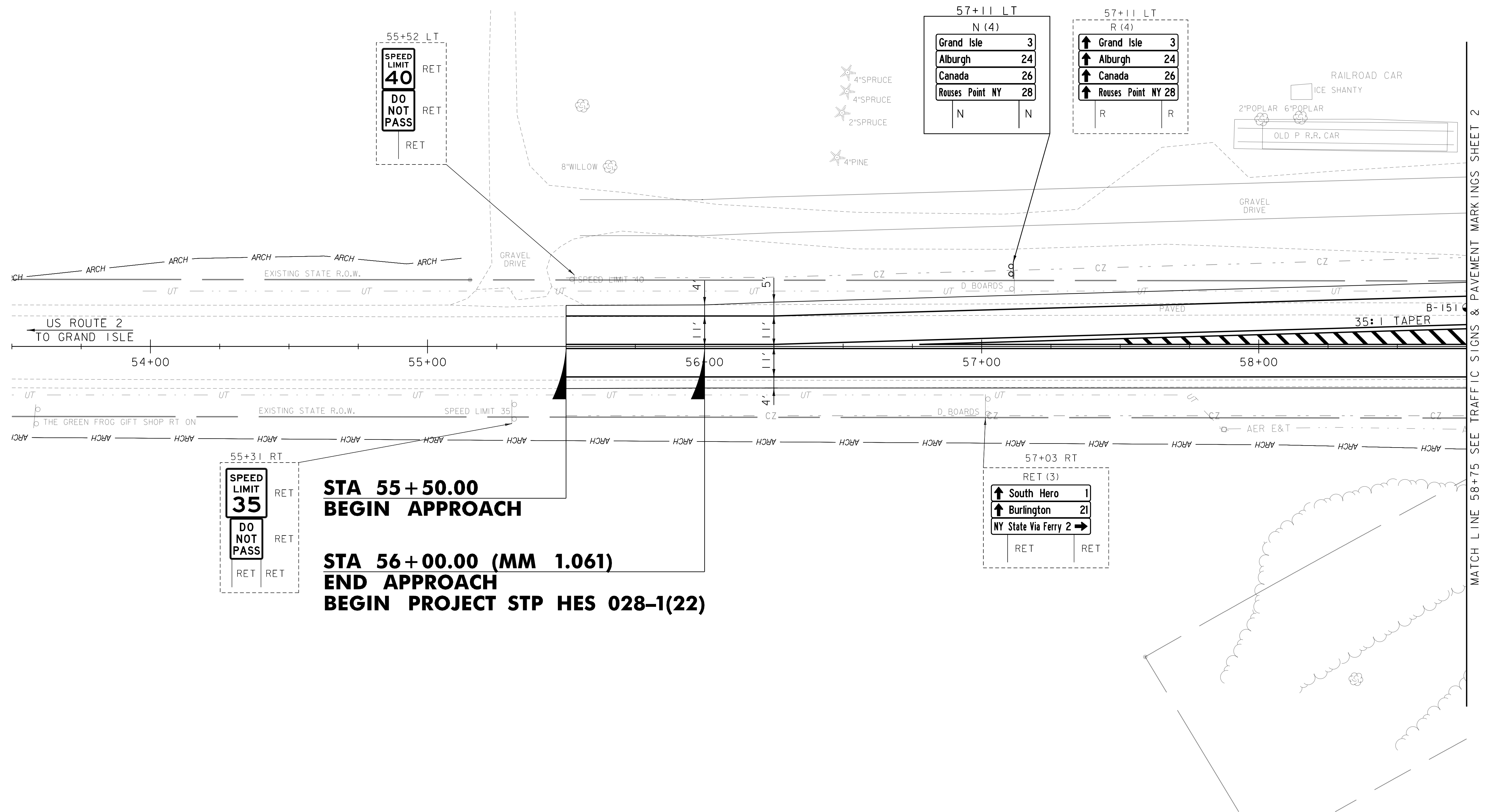
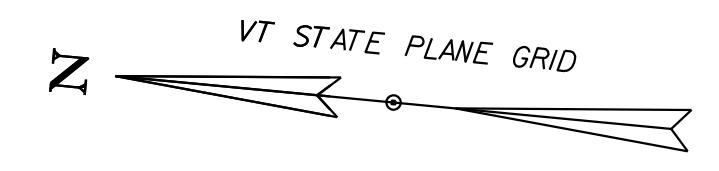

**STA 55+50.00  
 BEGIN APPROACH**

**STA 56+00.00 (MM 1.061)  
 END APPROACH  
 BEGIN PROJECT STP HES 028-1(22)**

57+11 LT	
N (4)	
Grand Isle	3
Alburgh	24
Canada	26
Rouses Point NY	28
N	N

57+11 LT	
R (4)	
↑ Grand Isle	3
↑ Alburgh	24
↑ Canada	26
↑ Rouses Point NY	28
R	R

57+03 RT	
RET (3)	
↑ South Hero	1
↑ Burlington	21
NY State Via Ferry 2	→
RET	RET

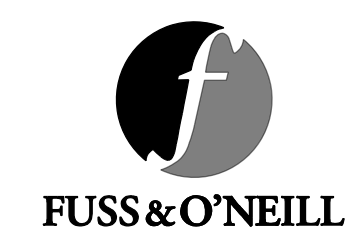

PROJECT NAME: SOUTH HERO  
 PROJECT NUMBER: STP HES 028-1(22)  
 FILE NAME: z12b016bdr\ts.dgn  
 PROJECT LEADER: P. SHEDD  
 DESIGNED BY: M. HALEY  
 TRAFFIC SIGNS & PAVEMENT MARKINGS SHEET 1 SHEET 48 OF 87  
 PLOT DATE: 8/5/2021  
 DRAWN BY: S. GOODWIN  
 CHECKED BY: P. SHEDD

MATCH LINE 58+75 SEE TRAFFIC SIGNS & PAVEMENT MARKINGS SHEET 2

TEMPORARY 4 INCH WHITE LINE, PAINT  
 DURABLE 4 INCH WHITE LINE, RECESSED POLYUREA  
 58+75 TO 60+37 RT (SOLID)  
 58+75 TO 63+25 LT (SOLID)  
 61+12 TO 63+25 LT (SOLID) (LANE LINE)  
 61+35 TO 63+25 RT (SOLID)  
 0+00 TO 2+00 LT (SOLID)  
 0+45 TO 2+00 RT (SOLID)

TEMPORARY 4 INCH YELLOW LINE, PAINT  
 DURABLE 4 INCH YELLOW LINE, RECESSED POLYUREA  
 58+75 TO 60+33 LT & RT (DOUBLE SOLID)  
 61+50 TO 63+25 LT & RT (SOLID)  
 0+25 TO 2+00 LT & RT (SOLID)  
 DURABLE 8 INCH YELLOW LINE, RECESSED POLYUREA  
 58+75 TO 60+30 LT (SOLID) (DIAGONALS)

TEMPORARY 24 INCH STOP BAR, PAINT  
 DURABLE 24 INCH STOP BAR, RECESSED POLYUREA  
 0+25 LT (12')

DURABLE LETTER OR SYMBOL, RECESSED POLYUREA  
 61+59 LT (LEFT TURN ARROW)  
 62+12 LT (ONLY)  
 62+65 LT (LEFT TURN ARROW)  
 63+18 LT (ONLY)  
 0+34 LT (STOP)

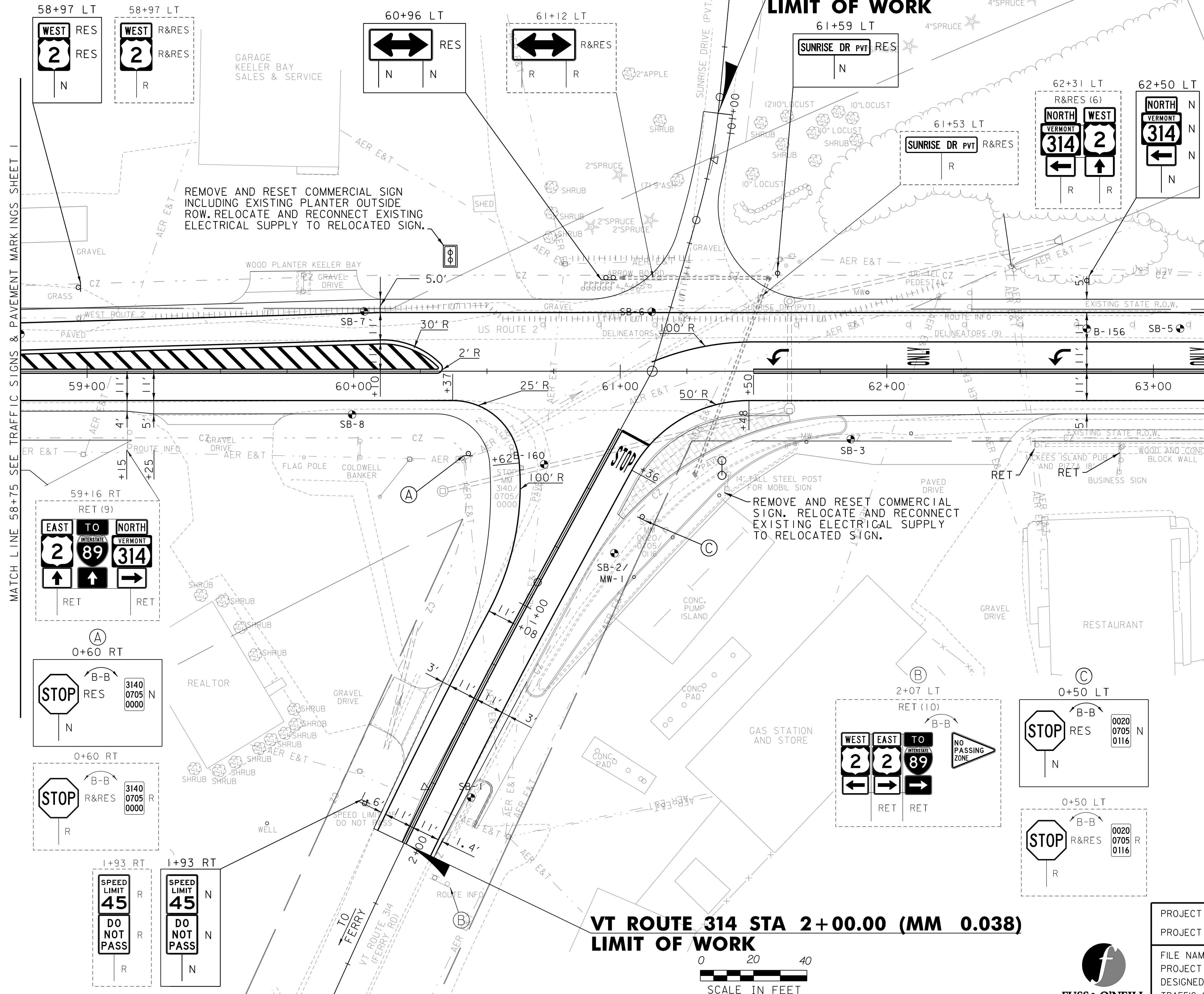
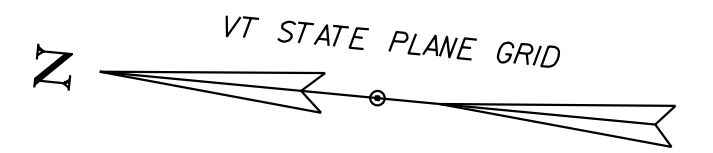

TEMPORARY LETTER OR SYMBOL, PAINT  
 61+59 LT (LEFT TURN ARROW)  
 62+65 LT (LEFT TURN ARROW)  
 0+34 LT (STOP)

SPECIAL PROVISION (REMOVE AND RESET COMMERCIAL SIGN AND PLANTER)  
 59+81 LT (RELOCATED TO 60+36 LT)

SPECIAL PROVISION (REMOVE AND RESET COMMERCIAL SIGN)  
 61+40 RT (RELOCATED TO 60+38 LT)

REMOVING SIGNS  
 AS SHOWN - 16

RESETTING SIGNS  
 AS SHOWN - 6

REMOVAL OF EXISTING DELINEATOR AND POST  
 60+71 TO 61+13 LT (3)  
 61+66 TO 63+13 LT (8)

MATCH LINE 58+75 SEE TRAFFIC SIGNS & PAVEMENT MARKINGS SHEET 1

MATCH LINE 63+25 SEE TRAFFIC SIGNS & PAVEMENT MARKINGS SHEET 3

**VT ROUTE 314 STA 2+00.00 (MM 0.038)  
 LIMIT OF WORK**



PROJECT NAME: SOUTH HERO  
 PROJECT NUMBER: STP HES 028-1(22)

FILE NAME: z12b016bdr\ts.dgn  
 PROJECT LEADER: P. SHEDD  
 DESIGNED BY: M. HALEY  
 TRAFFIC SIGNS & PAVEMENT MARKINGS SHEET 2 SHEET 49 OF 87

PLOT DATE: 8/5/2021  
 DRAWN BY: S. GOODWIN  
 CHECKED BY: P. SHEDD

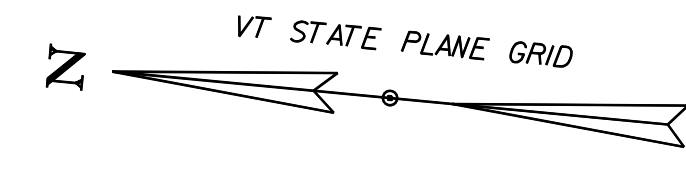

US ROUTE 2 STA 63+86.48 =  
 CHANNEL STA 1+75.00  
 ANGLE = 74°-00'-00" RT

**STA 63+81.45**  
**STOP ROADWAY**  
**BEGIN BRIDGE**

**STA 63+91.51**  
**END BRIDGE**  
**RESUME ROADWAY**

MATCH LINE 63+25 SEE TRAFFIC SIGNS & PAVEMENT MARKINGS SHEET 2

MATCH LINE 66+50 SEE TRAFFIC SIGNS & PAVEMENT MARKINGS SHEET 4

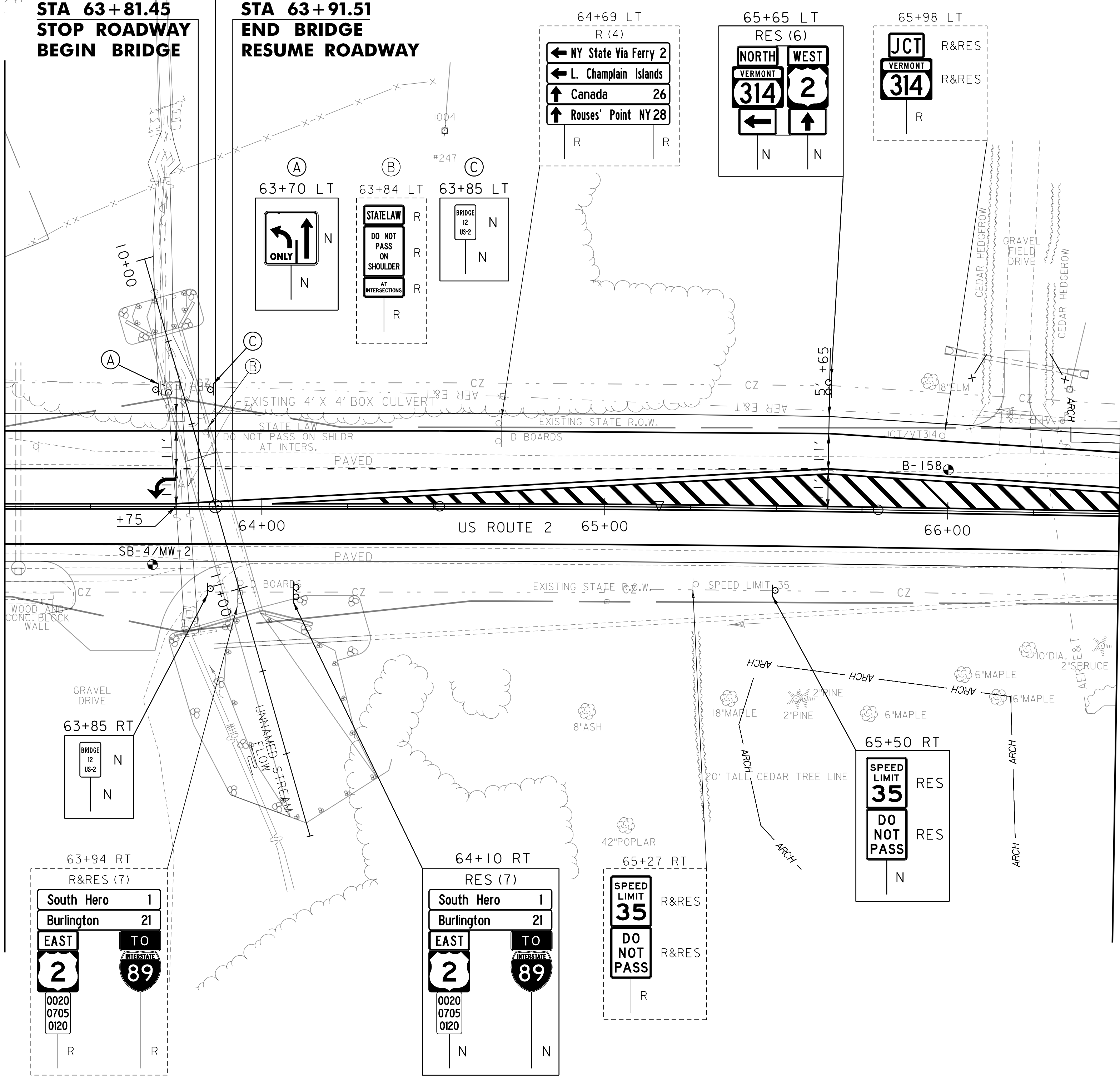

- TEMPORARY 4 INCH WHITE LINE, PAINT
- DURABLE 4 INCH WHITE LINE, RECESSED POLYUREA
- 63+25 TO 66+50 LT (SOLID)
- 63+25 TO 66+50 RT (SOLID)
- 63+25 TO 63+75 LT (SOLID) (LANE LINE)
- 63+75 TO 65+65 LT (SOLID) (DOTTED LINE)
- TEMPORARY 4 INCH YELLOW LINE, PAINT
- DURABLE 4 INCH YELLOW LINE, RECESSED POLYUREA
- 63+25 TO 63+75 LT & RT (SOLID)
- 63+75 TO 66+50 LT & RT (DOUBLE SOLID)
- DURABLE 8 INCH YELLOW LINE, RECESSED POLYUREA
- 64+34 TO 66+50 SOLID LT (SOLID) (DIAGONALS)
- TEMPORARY LETTER OR SYMBOL, PAINT
- DURABLE LETTER OR SYMBOL, RECESSED POLYUREA
- 63+71 LT (LEFT TURN ARROW)
- REMOVING SIGNS
- AS SHOWN - 18
- RESETTING SIGNS
- AS SHOWN - 15
- REMOVAL OF EXISTING DELINEATOR AND POST
- 63+34 LT

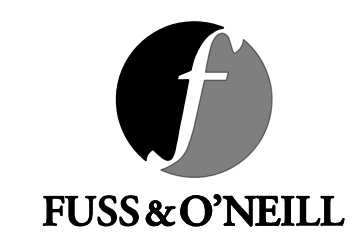

PROJECT NAME:	SOUTH HERO
PROJECT NUMBER:	STP HES 028-1(22)
FILE NAME:	z12b016bdr'ts.dgn
PROJECT LEADER:	P. SHEDD
DESIGNED BY:	M. HALEY
TRAFFIC SIGNS & PAVEMENT MARKINGS SHEET 3 SHEET	50 OF 87
PLOT DATE:	8/5/2021
DRAWN BY:	S. GOODWIN
CHECKED BY:	P. SHEDD



TEMPORARY 4 INCH WHITE LINE, PAINT  
 DURABLE 4 INCH WHITE LINE, RECESSED POLYUREA  
 66+50 TO 68+50 LT (SOLID)  
 66+50 TO 68+50 RT (SOLID)

TEMPORARY 4 INCH YELLOW LINE, PAINT  
 DURABLE 4 INCH YELLOW LINE, RECESSED POLYUREA  
 66+50 TO 67+90 LT & RT (DOUBLE SOLID)  
 67+90 TO 68+50 LT & RT (SOLID)

DURABLE 8 INCH YELLOW LINE, RECESSED POLYUREA  
 66+50 TO 67+90 LT (SOLID) (DIAGONALS)

REMOVING SIGNS  
 AS SHOWN - 2

RESETTING SIGNS  
 AS SHOWN - 3

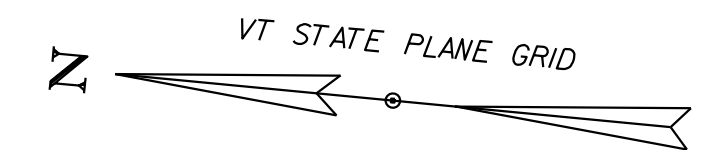

MATCH LINE 66+50 SEE TRAFFIC SIGNS & PAVEMENT MARKINGS SHEET 3

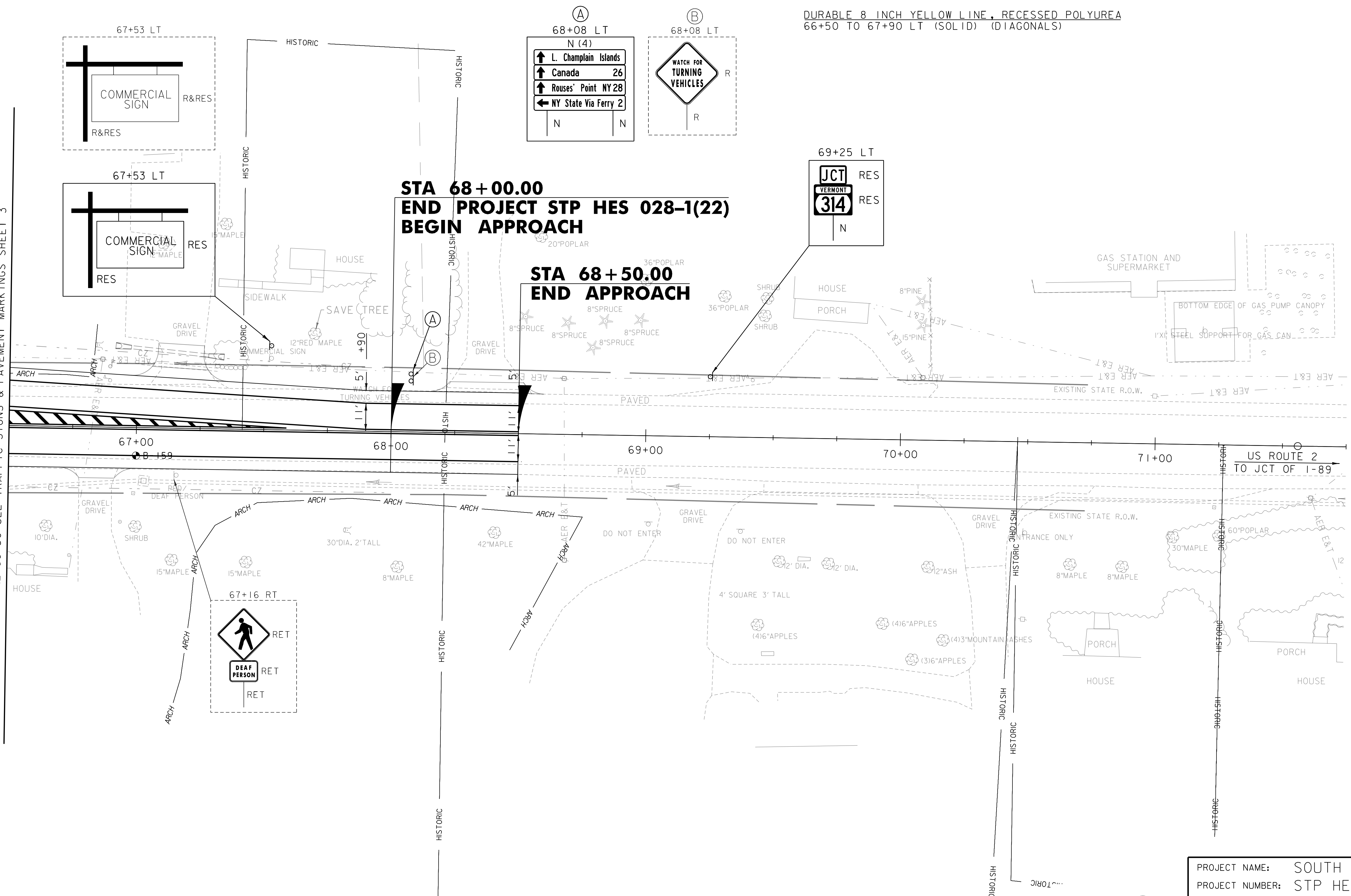

**STA 68+00.00**  
**END PROJECT STP HES 028-1(22)**  
**BEGIN APPROACH**

**STA 68+50.00**  
**END APPROACH**

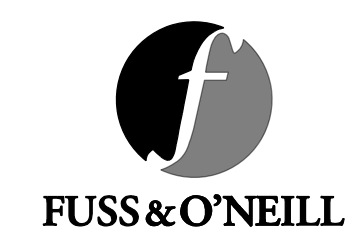
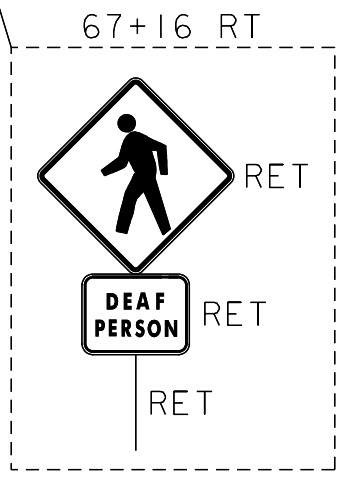
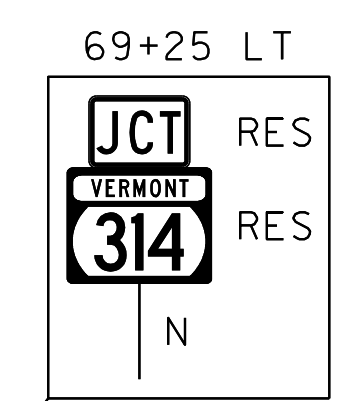
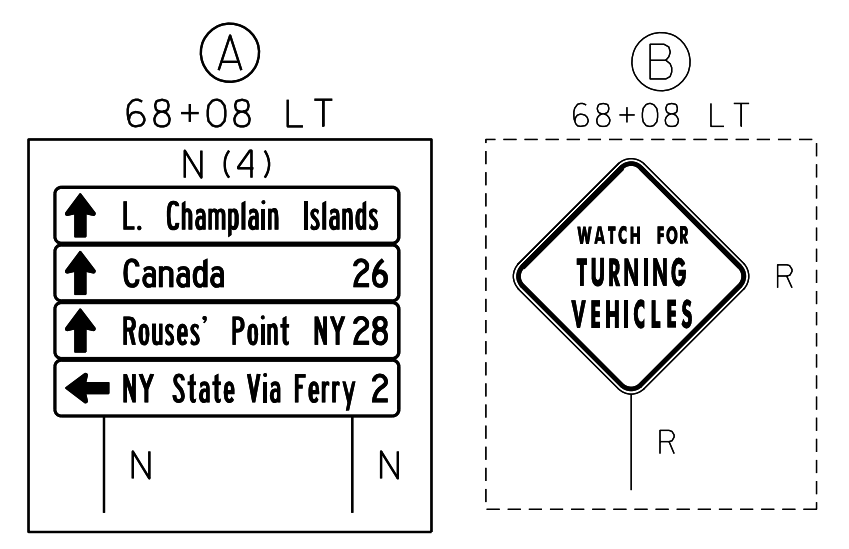

PROJECT NAME:	SOUTH HERO	FILE NAME:	z12b016bdr1ts.dgn	PLOT DATE:	8/5/2021
PROJECT NUMBER:	STP HES 028-1(22)	PROJECT LEADER:	P. SHEDD	DRAWN BY:	S. GOODWIN
		DESIGNED BY:	M. HALEY	CHECKED BY:	P. SHEDD
		TRAFFIC SIGNS & PAVEMENT MARKINGS SHEET 4 SHEET			51 OF 87

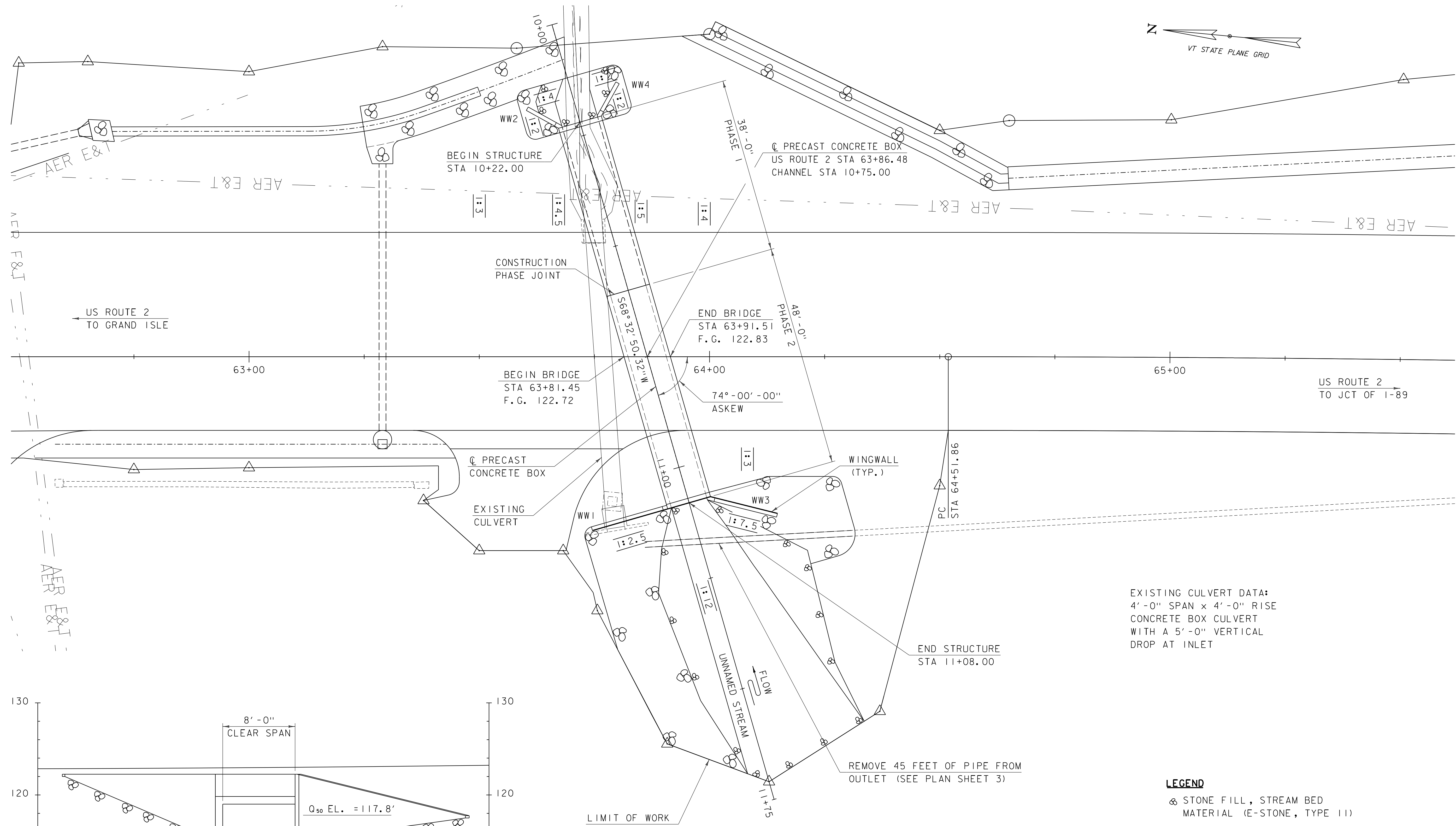
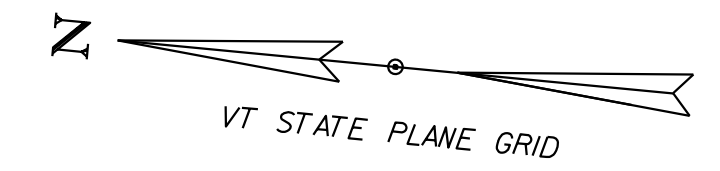

EXISTING CULVERT DATA:  
 4'-0" SPAN x 4'-0" RISE  
 CONCRETE BOX CULVERT  
 WITH A 5'-0" VERTICAL  
 DROP AT INLET

- LEGEND**
- ⊗ STONE FILL, STREAM BED MATERIAL (E-STONE, TYPE II)
  - ⊗ STONE FILL, TYPE II

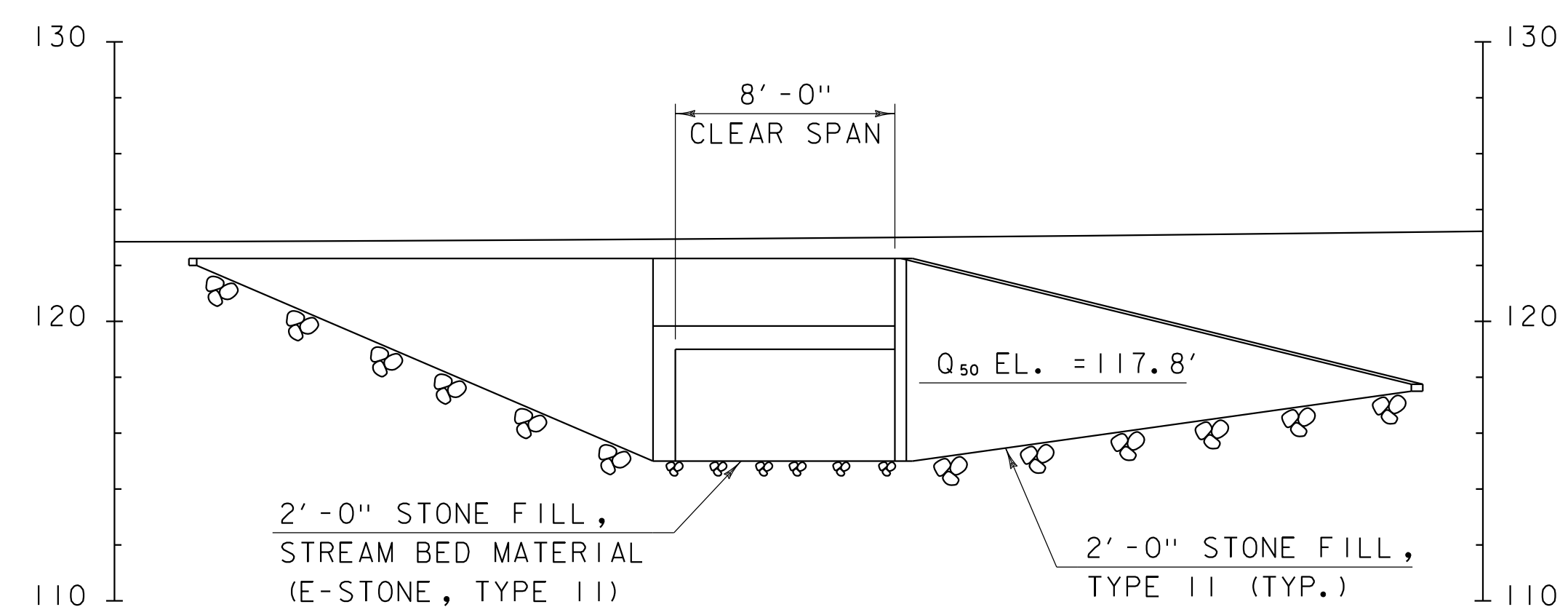

**UPSTREAM ELEVATION**

(LOOKING DOWNSTREAM)

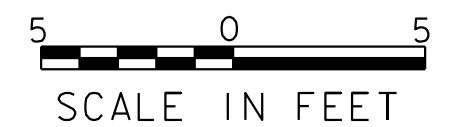

SCALE IN FEET



SCALE IN FEET

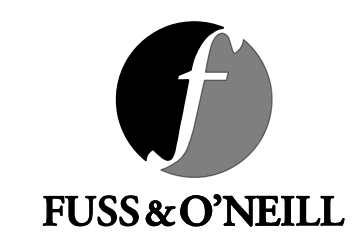

PROJECT NAME:	SOUTH HERO	PLOT DATE:	8/5/2021
PROJECT NUMBER:	STP HES 028-1(22)	DRAWN BY:	M. SMITH
FILE NAME:	z12b016pe.dgn	CHECKED BY:	S. BEAUMONT
PROJECT LEADER:	P. SHEDD	PLAN AND ELEVATION	SHEET 62 OF 87
DESIGNED BY:	K. CARME		

**NOTE**  
 REFER TO BOX CULVERT TCP PHASE I SIGNING SHEET FOR  
 TEMPORARY CONSTRUCTION SIGN PLACEMENT. ROUTE  
 MARKERS AND D-BOARDS IMPACTED BY THE TEMPORARY  
 TRAFFIC CONTROL SHALL BE RELOCATED AS APPROVED BY  
 THE ENGINEER.

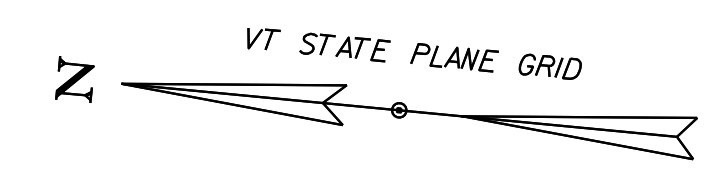

- ENERGY ABSORPTION ATTENUATOR, TEMPORARY  
 61+88 LT  
 65+85 LT
- TEMPORARY TRAFFIC BARRIER  
 61+97 TO 63+16 LT  
 64+56 TO 65+76 RT
- SPECIAL PROVISION (TEMPORARY  
 BRACED CONCRETE BARRIER)  
 63+16 TO 64+56 LT
- TEMPORARY 4 INCH WHITE LINE, PAINT  
 62+00 TO 65+75 LT (SOLID)  
 62+00 TO 65+75 RT (SOLID)
- TEMPORARY 4 INCH YELLOW LINE, PAINT  
 62+00 TO 65+75 RT (DOUBLE SOLID)

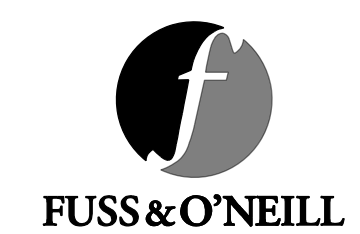
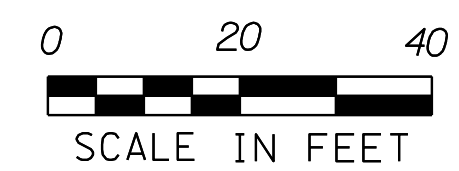
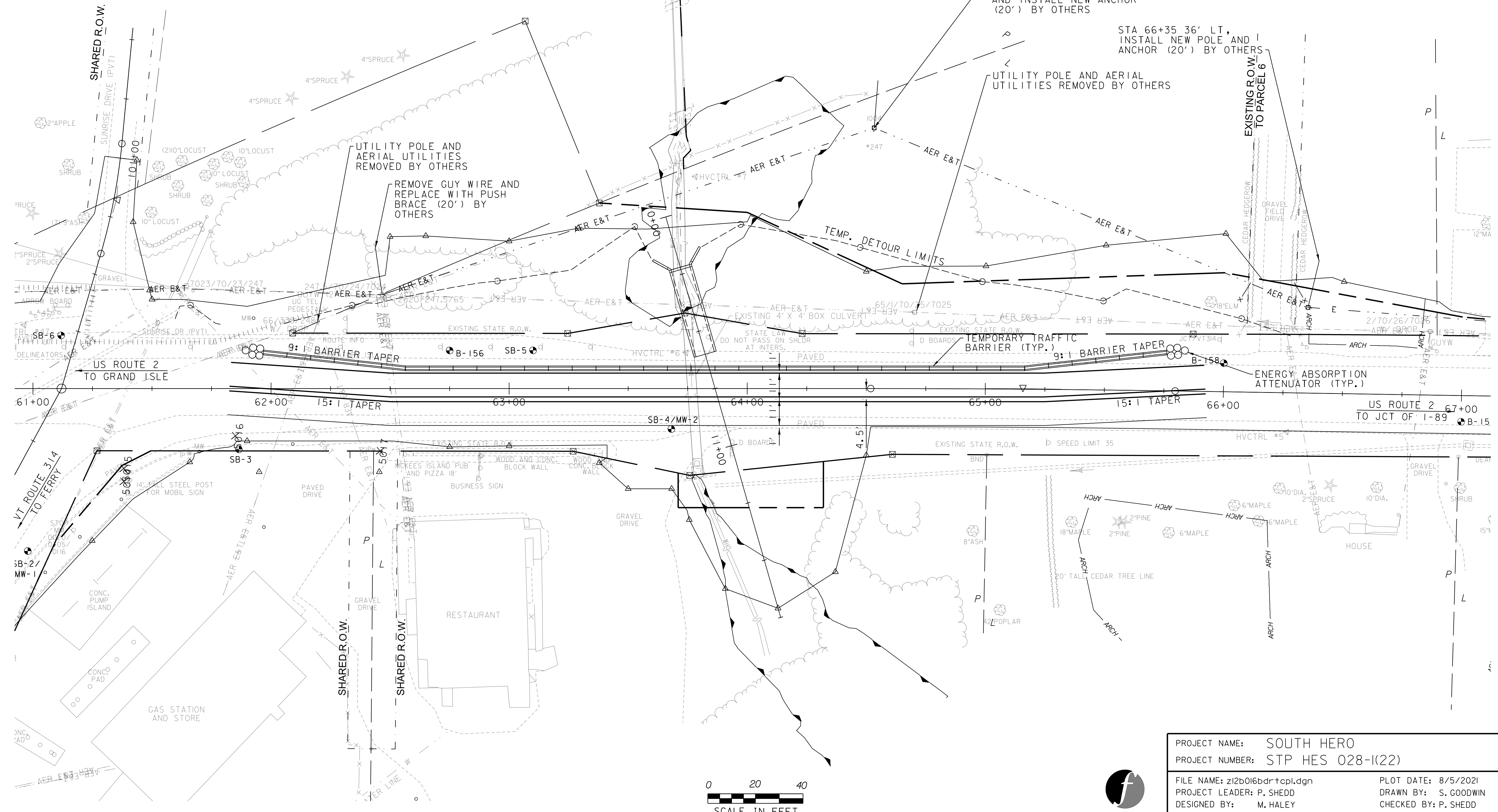

PROJECT NAME:	SOUTH HERO
PROJECT NUMBER:	STP HES 028-1(22)
FILE NAME:	z12b016bdr+tcp1.dgn
PROJECT LEADER:	P. SHEDD
DESIGNED BY:	M. HALEY
BOX CULVERT TCP PHASE I PLAN	
PLOT DATE:	8/5/2021
DRAWN BY:	S. GOODWIN
CHECKED BY:	P. SHEDD
SHEET	82 OF 87

ENERGY ABSORPTION ATTENUATOR, TEMPORARY  
 202+40 RT  
 206+09 LT

TEMPORARY TRAFFIC BARRIER  
 REMOVE AND RESET TEMPORARY TRAFFIC BARRIER  
 201+65 TO 203+04 LT  
 202+48 TO 203+10 RT  
 204+43 TO 206+00 LT  
 204+53 TO 205+77 RT

SPECIAL PROVISION (TEMPORARY BRACED  
 CONCRETE BARRIER)  
 SPECIAL PROVISION (REMOVE AND RESET  
 TEMPORARY BRACED CONCRETE BARRIER)  
 203+04 TO 204+43 LT  
 203+10 TO 204+53 RT

TEMPORARY 4 INCH WHITE LINE, PAINT  
 201+50 TO 207+06 LT (SOLID)  
 201+50 TO 207+06 RT (SOLID)

TEMPORARY 4 INCH YELLOW LINE, PAINT  
 201+50 TO 207+06 LT & RT (SOLID)

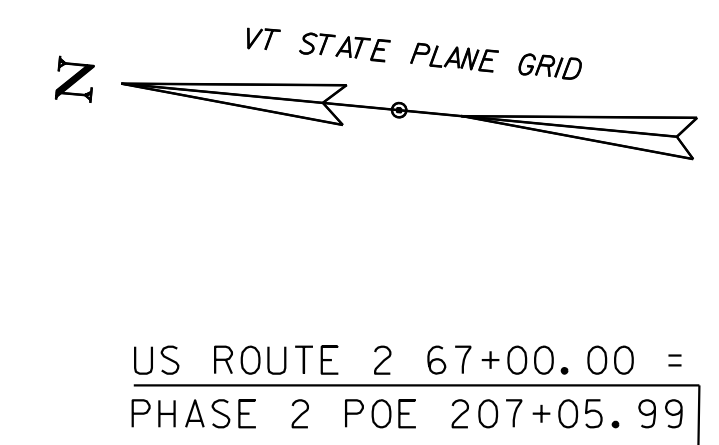
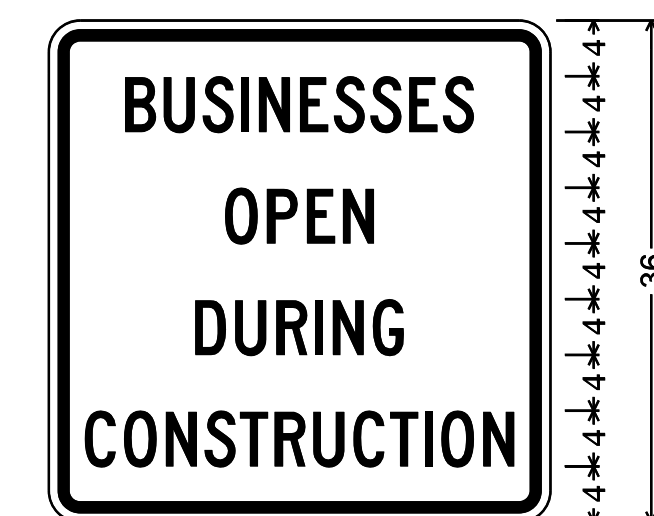

US ROUTE 2 POT 61+12.00 =  
 VT ROUTE 314 POT 00+00.00 =  
 SUNRISE DR POT 100+00.00 =  
 PHASE 2 POB 201+12.00

PHASE 2 CURVE (1)  
 DELTA = 14°42' 16" LT  
 D = 11°27' 33"  
 R = 500.00'  
 T = 64.51'  
 L = 128.32'  
 E = 4.14'  
 BRG BK S5°27' 10"E  
 BRG AH S20°09' 26"E  
 BANK = NC

PHASE 2 CURVE (4)  
 DELTA = 14°27' 11" LT  
 D = 11°27' 33"  
 R = 500.00'  
 T = 63.40'  
 L = 126.13'  
 E = 4.00'  
 BRG BK S9°54' 58"W  
 BRG AH S4°32' 13"E  
 BANK = NC

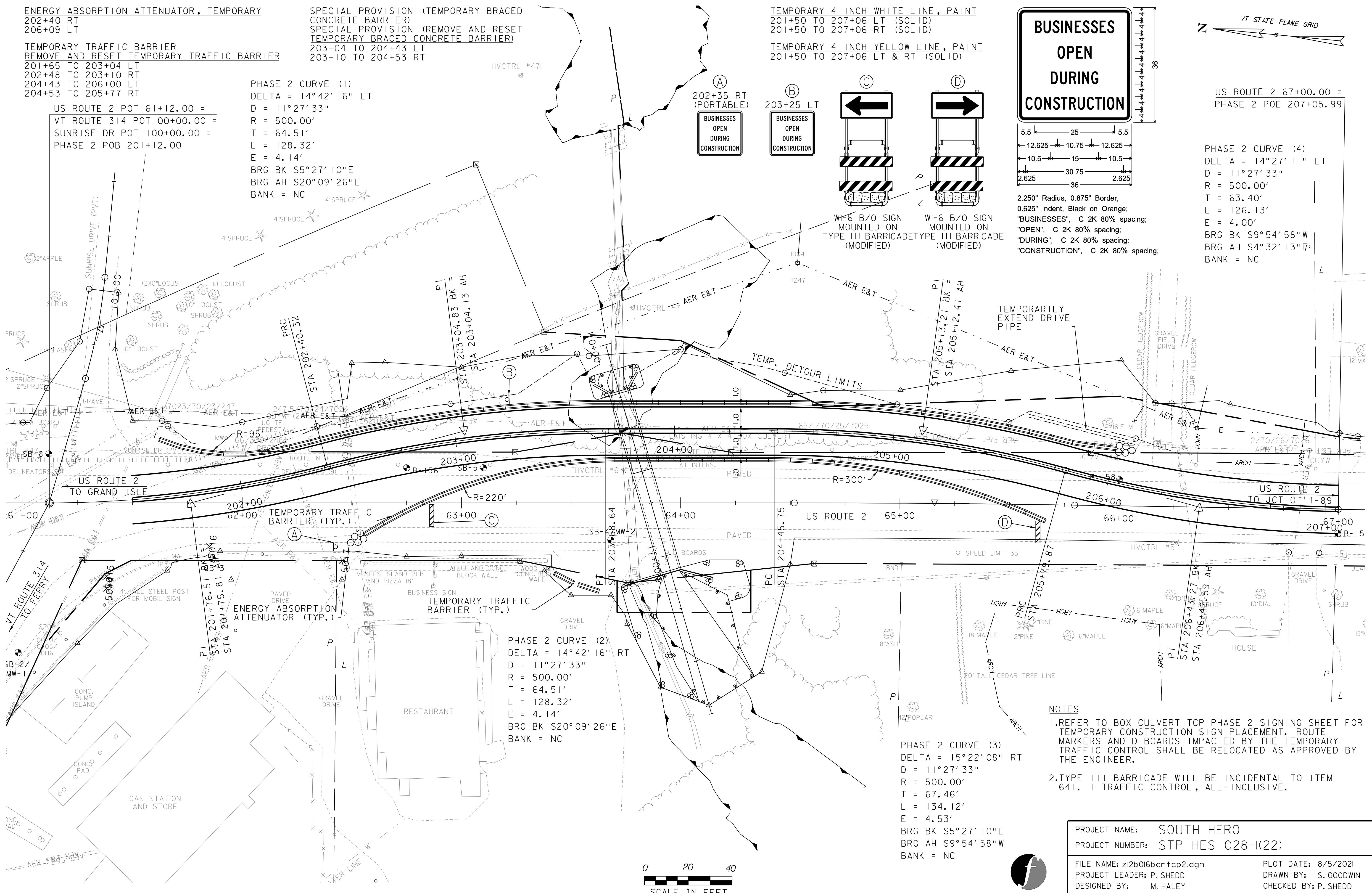

PHASE 2 CURVE (2)  
 DELTA = 14°42' 16" RT  
 D = 11°27' 33"  
 R = 500.00'  
 T = 64.51'  
 L = 128.32'  
 E = 4.14'  
 BRG BK S20°09' 26"E  
 BANK = NC

PHASE 2 CURVE (3)  
 DELTA = 15°22' 08" RT  
 D = 11°27' 33"  
 R = 500.00'  
 T = 67.46'  
 L = 134.12'  
 E = 4.53'  
 BRG BK S5°27' 10"E  
 BRG AH S9°54' 58"W  
 BANK = NC

NOTES  
 1. REFER TO BOX CULVERT TCP PHASE 2 SIGNING SHEET FOR TEMPORARY CONSTRUCTION SIGN PLACEMENT. ROUTE MARKERS AND D-BOARDS IMPACTED BY THE TEMPORARY TRAFFIC CONTROL SHALL BE RELOCATED AS APPROVED BY THE ENGINEER.  
 2. TYPE III BARRICADE WILL BE INCIDENTAL TO ITEM 641.11 TRAFFIC CONTROL, ALL-INCLUSIVE.

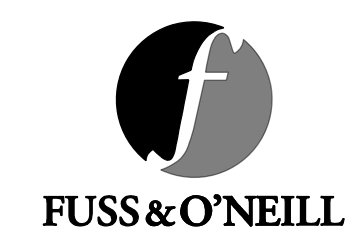

PROJECT NAME:	SOUTH HERO	FILE NAME:	z12b016bdr+tcp2.dgn	PLOT DATE:	8/5/2021
PROJECT NUMBER:	STP HES 028-1(22)	PROJECT LEADER:	P. SHEDD	DRAWN BY:	S. GOODWIN
		DESIGNED BY:	M. HALEY	CHECKED BY:	P. SHEDD
		BOX CULVERT TCP PHASE 2 PLAN		SHEET	83 OF 87